

GP1500-2 2V1500AH

GP SERIES-Telecom Battery



Specification

Nominal Voltage	2V	
Nominal Capacity(10HR)	1500AH	
Dimension	Length	336±3mm (13.22 inches)
	Width	288±3mm (11.33 inches)
	Container Height	340±3mm (13.38 inches)
	Total Height (with Terminal)	341±3mm (13.42 inches)
Approx Weight	Approx 86.5 kg (190.47lbs)	
Terminal	T11	
Container Material	ABS	
Rated Capacity	1535.0 AH/153.5A	(10hr, 1.80V/cell, 25°C/77°F)
	1325.0 AH/265.0A	(5hr, 1.75V/cell, 25°C/77°F)
	1212.9AH/404.3A	(3hr, 1.75V/cell, 25°C/77°F)
	945.0 AH/945.0A	(1hr, 1.60V/cell, 25°C/77°F)
Max. Discharge Current	12000A (5s)	
Internal Resistance	Approx 0.35 mΩ	
Operating Temp.Range	Discharge : -15~50°C (5~122°F)	
	Charge : 0~40°C (32~104°F)	
	Storage : -15~40°C (5~104°F)	
Nominal Operating Temp. Range	25±3°C (77±5°F)	
Cycle Use	Initial Charging Current less than 450.0 A.Voltage	
	2.4V~2.5 V at 25 °C(77 °F)Temp. Coefficient -5mV/°C	
Standby Use	No limit on Initial Charging Current Voltage	
	2.25V~2.3V at 25 °C(77 °F)Temp. Coefficient -3mV/°C	
Capacity affected by Temperature	40°C (104 °F)	103%
	25°C (77 °F)	100%
	0°C (32 °F)	86%
Self Discharge	JYC GP series batteries may be stored for up to 6 months at 25°C(77°F) and then a freshening charge is required. For higher temperatures the time interval will be shorter.	

Applications

- ◆ Tele-communication central station (wired or cellular)
- ◆ Power system communication, military communication, etc.
- ◆ Network communication including: data transmission, television signal transmission, etc.
- ◆ Uninterruptable Power System (UPS- for Telecom)

ISO 9001	ISO 14001	OHSAS 18001	TLC
CE	RoHS	UL	PV Battery

Constant Current Discharge (Amperes) at 25 °C (77°F)

End	15min	30min	45min	1h	2h	3h	4h	5h	10h
1.60V	2320	1647	1284	945	649.1	428.2	323.1	275.1	155.8
1.65V	2290	1619	1241	930	622.2	422.1	317.2	271.0	155.5
1.70V	2200	1555	1198	915	607.0	419.0	311.0	270.2	155.1
1.75V	2046	1462	1137	887	585.3	404.3	302.3	265.0	154.4
1.80V	1923	1416	1082	848	552.4	389.0	295.4	259.4	153.5

Constant Power Discharge (Watts) at 25 °C (77°F)

End	15min	30min	45min	1h	2h	3h	4h	5h	10h
1.60V	4371	3078	2277	1625	1177.0	837.1	634.1	538.0	310.2
1.65V	4297	3017	2244	1616	1168.2	831.2	628.2	535.2	308.4
1.70V	4156	2934	2165	1601	1155.3	822.0	613.0	532.3	306.6
1.75V	3925	2804	2073	1524	1104.0	795.3	595.3	526.2	304.5
1.80V	3659	2592	1942	1448	1061.1	762.4	583.2	514.0	302.2

Note The above data are average values, and can be obtained with 3 charge/discharge cycles. These are not minimum values.

GP1500-2 2V1500AH

GP SERIES-Telecom Battery

Dimensions

T11 Terminal

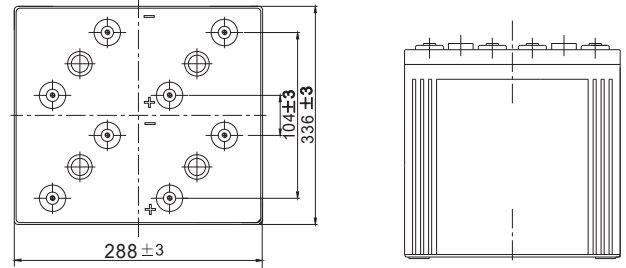
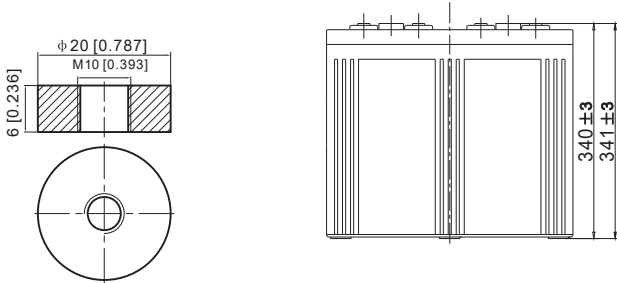

Float Charging Characteristics

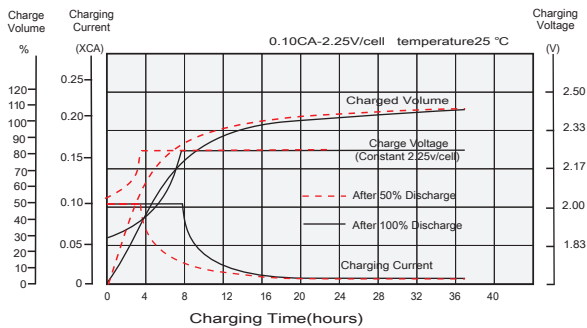

Discharge Characteristics

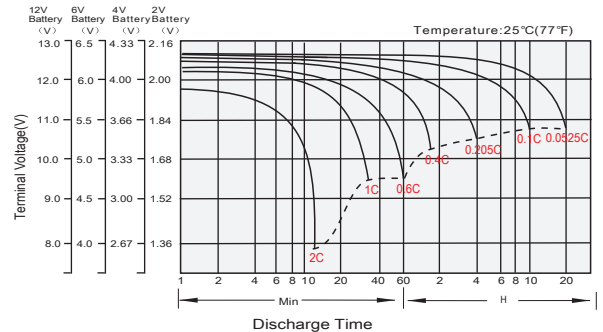

Temperature Effects in Relation to Battery Capacity

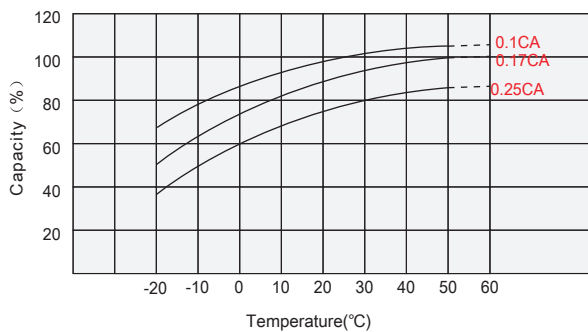

Effect of Temperature on Long Term Float Life

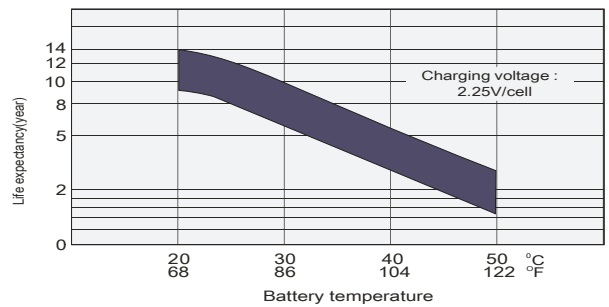

Cycle Life in Relation to Depth of Discharge

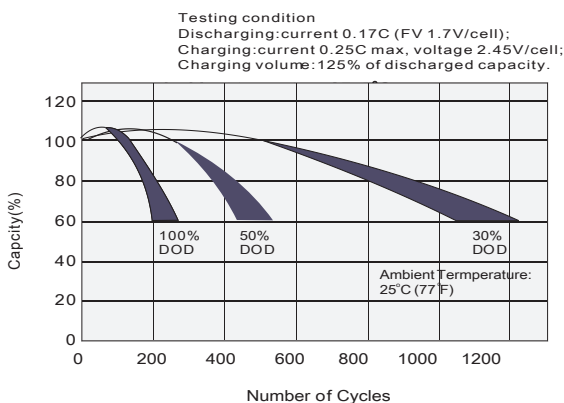

Self Discharge Characteristics

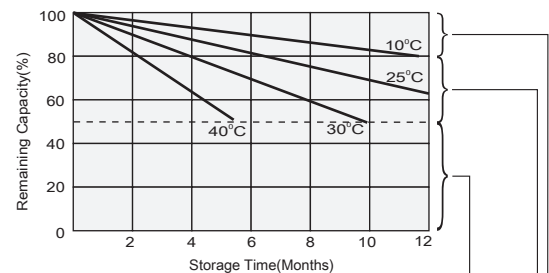

Supplementary charge may often fail to recover the capacity. The battery should never be left standing till this is reached.

Supplementary charge required before use. Optimal charging way as below:
 1. Charged for a above 3 days at limited current 0.25CA and constant voltage 2.25V/cell.
 2. Charged for a above 20 hours at a limited current 0.25CA and constant voltage 2.45V/cell.
 3. Charged for 8-10 hours at limited current 0.05CA.

No supplementary charge required
 (Carry out supplementary charge before use if 100% capacity is required.)